

MXG 938

EXTREME

Scotsman
Ice Systems

Modular Ice Machine up to 400 kg

Item #:
Project:
Quantity:



FEATURES

- Individual transparent solid cube: each single cube is an artwork: crystal clear and perfectly shaped, faithful to the Scotsman tradition.
- Global standard footprint: strictly follows international imperial standard commonly adopted in the industry of reference.
- Agion: the technology that makes products cleaner and longer lasting with built-in protection working 24/7 to resist the growth of microbes and the development of unpleasant odors.
- Electronic control: ambient and water temperatures may change throughout the years but your ice will stay the same.
- External indicator lights: keeps ice maker's operations under constant surveillance.
- Front access condenser air filter: a do-it-yourself cleaning operation that saves time and money and makes your ice maker live longer.
- Clean alert: advises with a blink when it's time to clean the filter.
-



MXG L 938
Large Gourmet 39 g
Ø 38 x H 41 mm



MXG M 938
Medium Gourmet 20 g
Ø 30 x H 34 mm

CONDENSING SYSTEM

Air cooled
Remote condenser
Water cooled

REFRIGERANT GAS

R404A

VOLTAGE V/Hz/ph

230/60/3
400/50/3N

RECOMMENDED BINS

Head	Bins		kg
	✓	SB393	
✓	SB530	243	
BINTOPMKG5B55	SB550	252	
MXG 938	CBT48EAMCD	SB948	406
	CBT52EAMCD	SB1025	478
	●	UBH1600	812
	●	SIS1350	613 + 73 + 73

LEGEND:

- ✓ : Perfect combination between ice maker and bin
- : Ice chute cut-out performed upon installation
- CBTxxxxxxx : need additional bin top

Certifications:



OPERATING REQUIREMENTS

	Minimum	Maximum
Air temperature	10°C	43°C
Water temperature	5°C	38°C
Water pressure	1 bar (14 psi)	5 bar (70 psi)
Electrical voltage	-10%	+10%

IMPORTANT NOTICE:
Models and specifications are subject to change without notice. This spec sheet is meant for commercial purpose only. For technical documentation please refer to our service manuals.

Download our free **App Scotsman Ice**
Apple store
Google play
Windows store



www.scotsman-ice.it
www.scotsman-ice.com

Modular Ice Machine up to 400 kg

MXG 938

EXTREME

Scotsman
Ice Systems

Modular Ice Machine up to 400 kg

Item #:
Project:
Quantity:

Modular Ice Machine up to 400 kg

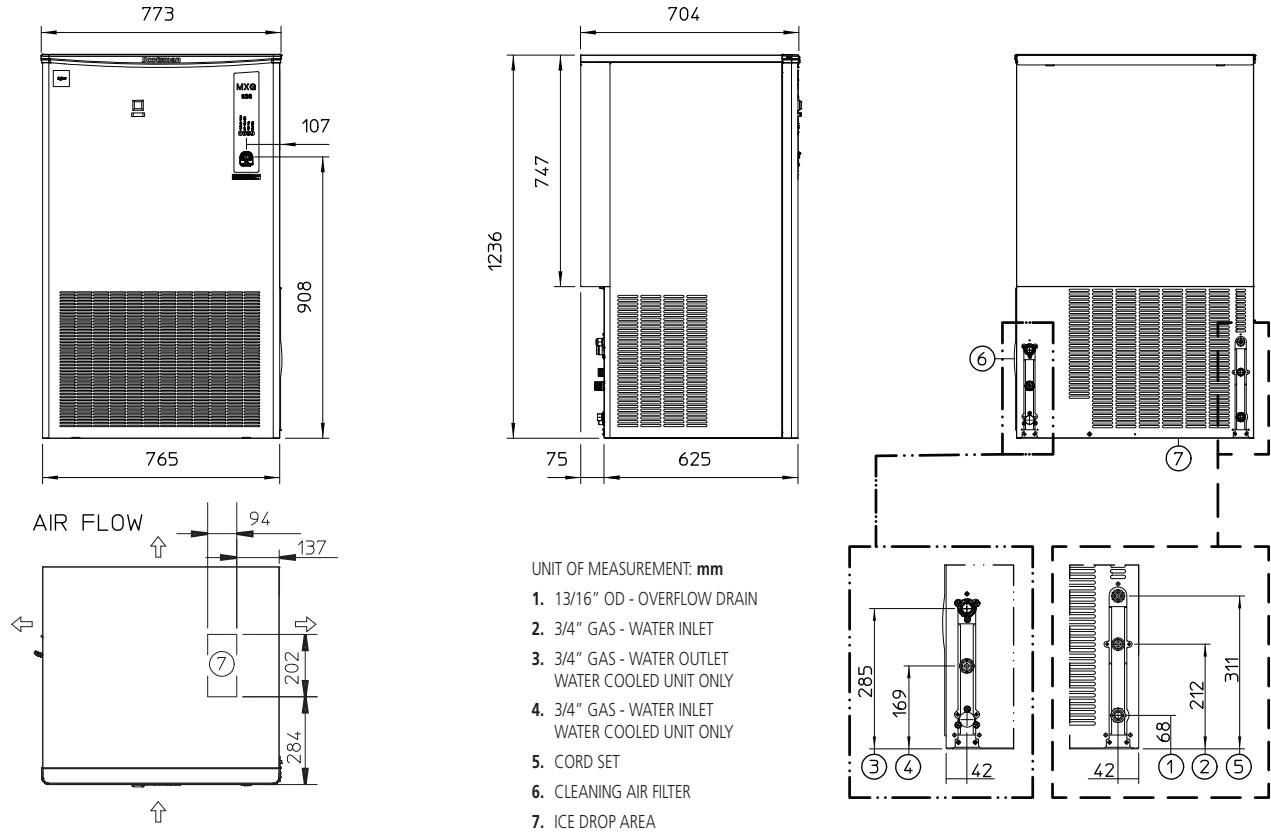

UNIT DATA	Version		Compressor		Circuit wires		Max. fuse size
	Version	Voltage	Btu/h	W	No.	Ømm ²	A
Size (W x D x H)	773 x 704 x 1236 mm						
Net weight	143 kg						
SHIPPING DATA	Carton (W x D x H)		830 x 770 x 1430 mm				
Weight	158 kg						

Version	Condensation	Voltage	24 h ice production kg °C Amb. / °C Water			Energy consumption*		Water usage*	Instant power
			10°C/10°C	21°C/10°C	32°C/21°C	kWh/100 kg	kWh/24h	l/h	W
MXG L 938 AS	Air	400/50/3N	330	325	250	28.4	71.0	43.1	3200
MXG M 938 AS	Air	400/50/3N	400	375	300	22.0	69.3	37.5	3200
MXG M 938 AS	Air	230/60/3	400	375	300	22.0	69.3	37.5	3200
MXG M 938 ASR	Remote	400/50/3N	400	395	345	20.5	69.6	43.8	3200
MXG L 938 WS	Water	400/50/3N	330	328	300	21.8	65.5	195.8	3000
MXG M 938 WS	Water	400/50/3N	400	380	350	19.0	66.5	191.7	2800

(*) Data refer to 32°C Amb. / 21°C Water temperature conditions